

PG 100

	i	Mc [kNm]				n1max [min ⁻¹]	Pt [kW]	Kg				
		n2 x h	n2 x h	n2 x h	n2 x h			M	P	CPC	F	FS
		10.000	20.000	50.000	100.000							
PG 101	3.55	1.24	1.10	0.94	0.83	2800	12	13	15	18	11	14
	4.28	1.24	1.10	0.94	0.83							
	5.60	0.90	0.80	0.68	0.60							
	6.75	0.79	0.70	0.60	0.53							
	8.67	0.51	0.45	0.38	0.34							
PG 102	12.6	1.24	1.10	0.94	0.83	2800	8	19	21	24	17	20
	15.2	1.24	1.10	0.94	0.83							
	19.9	1.24	1.10	0.94	0.83							
	23.9	1.24	1.10	0.94	0.83							
	28.9	1.24	1.10	0.94	0.83							
	31.4	0.90	0.80	0.68	0.60							
	37.8	0.90	0.80	0.68	0.60							
	45.5	0.79	0.70	0.60	0.53							
	58.5	0.79	0.70	0.60	0.53							
PG 103	54.1	1.24	1.10	0.94	0.83	2800	5	25	27	30	23	26
	65.3	1.24	1.10	0.94	0.83							
	70.7	1.24	1.10	0.94	0.83							
	78.7	1.24	1.10	0.94	0.83							
	85.3	1.24	1.10	0.94	0.83							
	102.8	1.24	1.10	0.94	0.83							
	111.5	1.24	1.10	0.94	0.83							
	134.3	1.24	1.10	0.94	0.83							
	161.9	1.24	1.10	0.94	0.83							
	172.5	1.24	1.10	0.94	0.83							
	207.9	1.24	1.10	0.94	0.83							
	211.6	0.90	0.80	0.68	0.60							
	255.1	0.90	0.80	0.68	0.60							
	271.7	0.90	0.80	0.68	0.60							
	307.5	0.79	0.70	0.60	0.53							
	327.5	0.90	0.80	0.68	0.60							
	394.8	0.79	0.70	0.60	0.53							
PG 104	337.3	1.24	1.10	0.94	0.83	2800	1.5	31	33	36	29	32
	365.7	1.24	1.10	0.94	0.83							
	396.4	1.24	1.10	0.94	0.83							
	440.8	1.24	1.10	0.94	0.83							
	477.8	1.24	1.10	0.94	0.83							
	531.3	1.24	1.10	0.94	0.83							
	575.9	1.24	1.10	0.94	0.83							
	624.4	1.24	1.10	0.94	0.83							
	694.2	1.24	1.10	0.94	0.83							
	752.6	1.24	1.10	0.94	0.83							
	836.8	1.24	1.10	0.94	0.83							
	907.1	1.24	1.10	0.94	0.83							
	966.3	1.24	1.10	0.94	0.83							
	1093.4	1.24	1.10	0.94	0.83							
	1144.5	1.24	1.10	0.94	0.83							
	1185.4	0.90	0.80	0.68	0.60							
	1318.0	1.24	1.10	0.94	0.83							
	1428.8	0.90	0.80	0.68	0.60							
	1692.3	1.24	1.10	0.94	0.83							
	3422.1	0.79	0.70	0.60	0.53							

PG 100

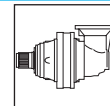

	i	Mc [kNm]				n1max [min ⁻¹]	Pt [kW]	Kg				
		n ₂ x h	n ₂ x h	n ₂ x h	n ₂ x h			M	P	CPC	F	FS
		10.000	20.000	50.000	100.000							
PGA 102	10.4	1.24	1.10	0.94	0.83	2800	8	28	30	33	26	29
	12.5	1.24	1.10	0.94	0.83							
	16.4	0.90	0.80	0.68	0.60							
	19.7	0.79	0.70	0.60	0.53							
PGA 103	37.0	1.24	1.10	0.94	0.83	2800	5	34	36	39	32	35
	44.6	1.24	1.10	0.94	0.83							
	53.8	1.24	1.10	0.94	0.83							
	58.4	1.24	1.10	0.94	0.83							
	70.3	1.24	1.10	0.94	0.83							
	84.8	1.24	1.10	0.94	0.83							
	91.9	0.90	0.80	0.68	0.60							
	110.8	0.90	0.80	0.68	0.60							
	133.6	0.79	0.70	0.60	0.53							
	171.5	0.79	0.70	0.60	0.53							
PGA 104	131.8	1.24	1.10	0.94	0.83	2800	1.5	40	42	45	38	41
	158.9	1.24	1.10	0.94	0.83							
	191.5	1.24	1.10	0.94	0.83							
	207.6	1.24	1.10	0.94	0.83							
	230.8	1.24	1.10	0.94	0.83							
	301.7	1.24	1.10	0.94	0.83							
	327.0	1.24	1.10	0.94	0.83							
	363.6	1.24	1.10	0.94	0.83							
	394.2	1.24	1.10	0.94	0.83							
	475.1	1.24	1.10	0.94	0.83							
	515.3	0.90	0.80	0.68	0.60							
	572.7	1.24	1.10	0.94	0.83							
	610.1	1.24	1.10	0.94	0.83							
	735.4	1.24	1.10	0.94	0.83							
	797.2	0.90	0.80	0.68	0.60							
	960.9	0.90	0.80	0.68	0.60							
	1158.2	0.79	0.70	0.60	0.53							
	1233.7	0.90	0.80	0.68	0.60							
1487.1	0.79	0.70	0.60	0.53								



(n₂ x h = 20.000)

$$M_{\max} = M_c \times 2$$

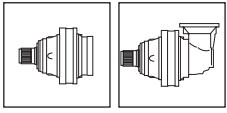

PG 100

MS

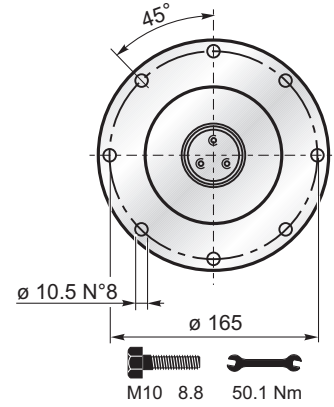
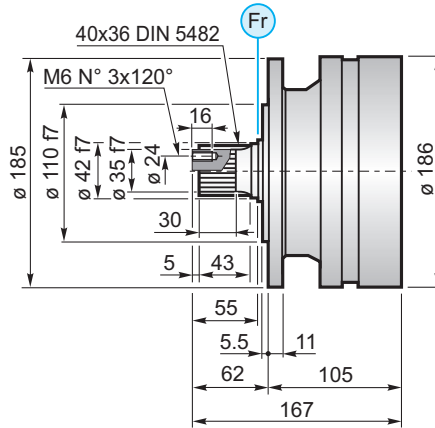
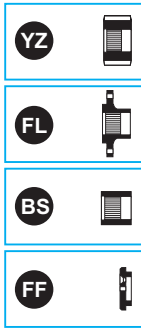

MC

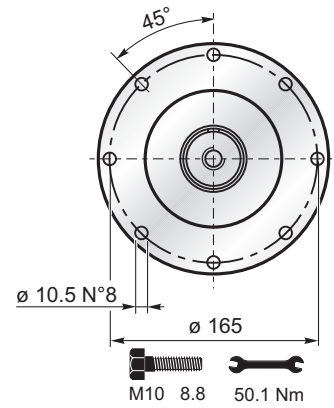
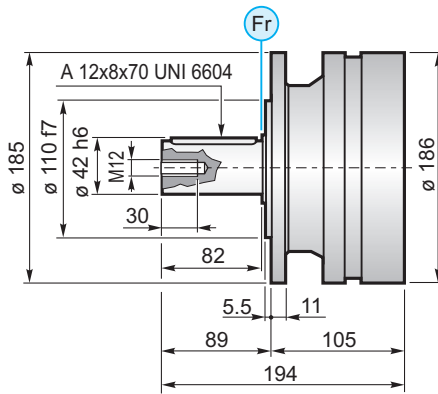

PS

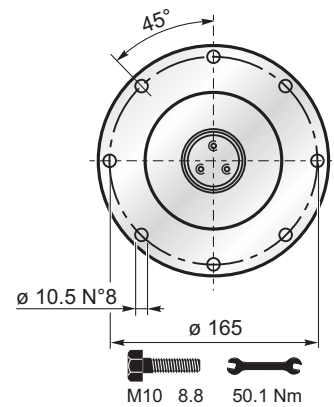
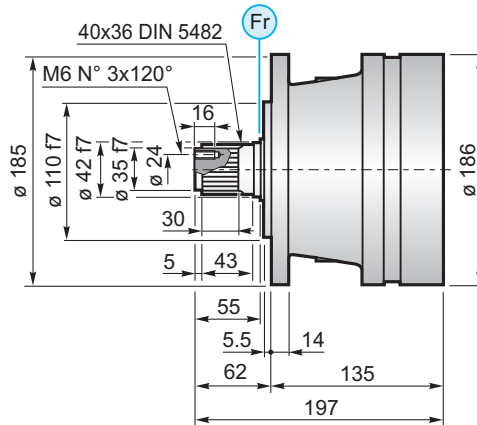
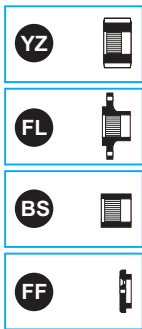

PC

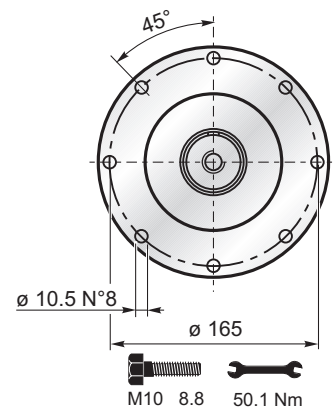
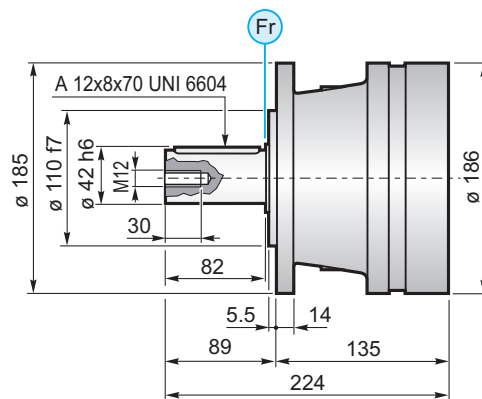

PG 100

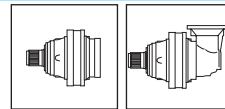

F

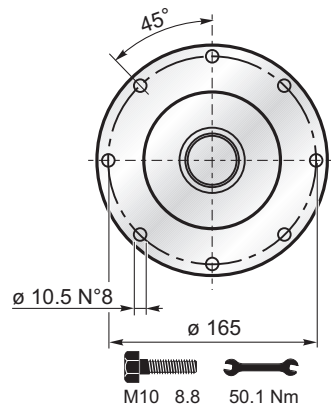
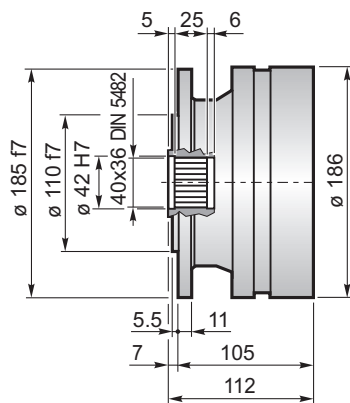

FS

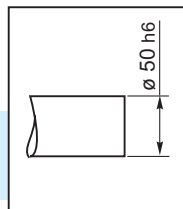
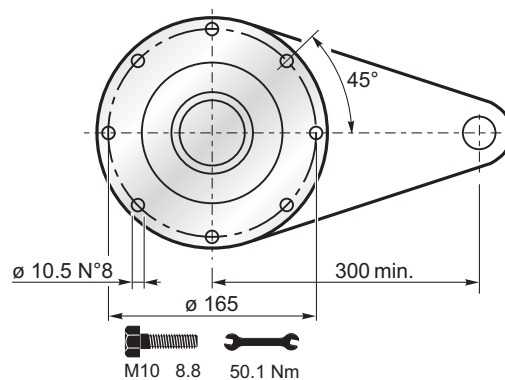
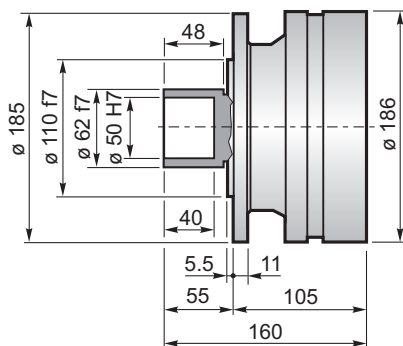

$M_{max} = 2.2 \text{ kNm}$

La coppia massima indicata è valida solo con calettatori forniti da SOM
 The maximum torque indicated is valid only with shrink discs supplied by SOM
 Le couple maximal indiqué n'est valable qu'avec les frettes de serrage fournis par SOM
 Das dargestellte, maximale Drehmoment gilt nur mit von SOM gelieferter Schrumpfscheibe

CPC

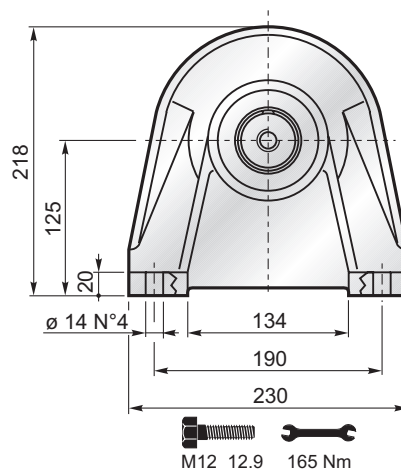
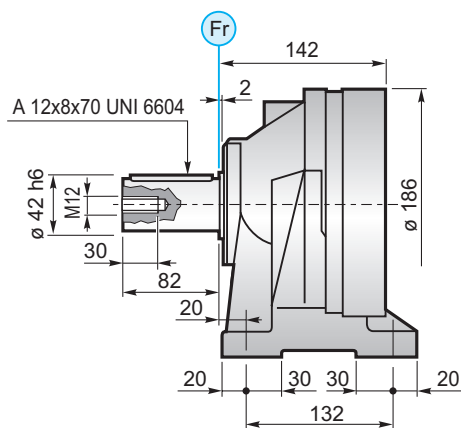

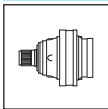

PG 100

	PG ...MS					
	A	B	RA	RB	EF	EDF
PG 101	105	167	•			•
PG 102	153	215	•			•
PG 103	201	263	•			•
PG 104	249	311	•			•

	PG ...MC					
	A	B	RA	RB	EF	EDF
PG 101	105	194	•			•
PG 102	153	242	•			•
PG 103	201	290	•			•
PG 104	249	338	•			•

	PG ...PS					
	A	B	RA	RB	EF	EDF
PG 101	135	197	•			•
PG 102	183	245	•			•
PG 103	231	293	•			•
PG 104	271	341	•			•

	PG ...PC					
	A	B	RA	RB	EF	EDF
PG 101	135	224	•			•
PG 102	183	272	•			•
PG 103	231	320	•			•
PG 104	279	368	•			•

	PG ...F					
	A	B	RA	RB	EF	EDF
PG 101	105	112	•			•
PG 102	153	160	•			•
PG 103	201	208	•			•
PG 104	249	256	•			•

	PG ...FS					
	A	B	RA	RB	EF	EDF
PG 101	105	160	•			•
PG 102	153	208	•			•
PG 103	201	256	•			•
PG 104	249	304	•			•

	PG ...CPC					
	A	B	RA	RB	EF	EDF
PG 101	135	224	•			•
PG 102	183	272	•			•
PG 103	231	320	•			•
PG 104	279	368	•			•

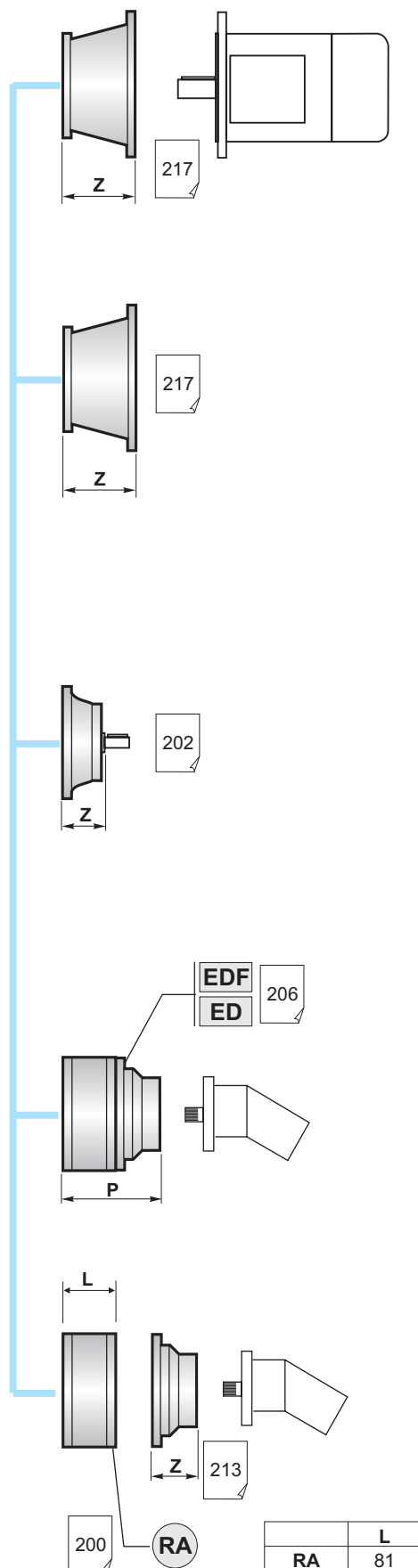

PG 100

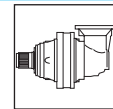

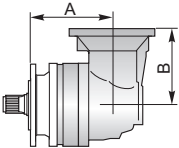
	PGA ...MS				
	A	B	RA	RB	EF
PGA 102	180	159	•		•
PGA 103	228	159	•		•
PGA 104	276	159	•		•

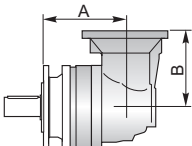
	PGA ...MC				
	A	B	RA	RB	EF
PGA 102	180	159	•		•
PGA 103	228	159	•		•
PGA 104	276	159	•		•

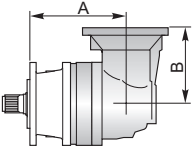
	PGA ...PS				
	A	B	RA	RB	EF
PGA 102	210	159	•		•
PGA 103	258	159	•		•
PGA 104	306	159	•		•

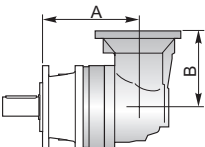
	PGA ...PC				
	A	B	RA	RB	EF
PGA 102	210	159	•		•
PGA 103	258	159	•		•
PGA 104	306	159	•		•

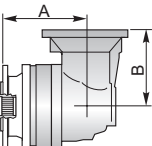
	PGA ...F				
	A	B	RA	RB	EF
PGA 102	180	159	•		•
PGA 103	228	159	•		•
PGA 104	276	159	•		•

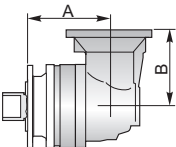
	PGA ...FS				
	A	B	RA	RB	EF
PGA 102	180	159	•		•
PGA 103	228	159	•		•
PGA 104	276	159	•		•

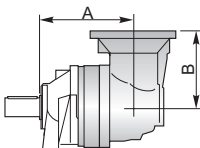
	PGA ...CPC				
	A	B	RA	RB	EF
PGA 102	217	159	•		•
PGA 103	265	159	•		•
PGA 104	313	159	•		•

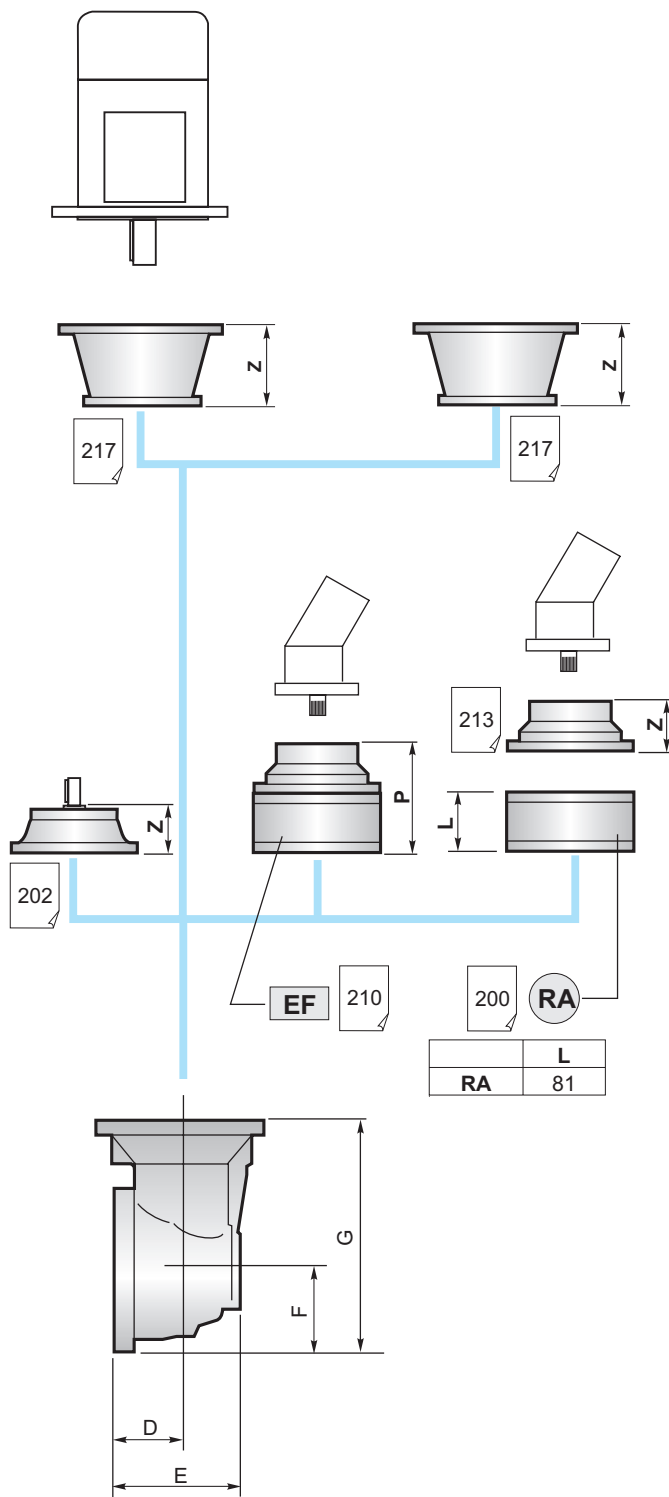

	D	E	F	G
PGA 102	75	141.5	93	252
PGA 103	75	141.5	93	252
PGA 104	75	141.5	93	252

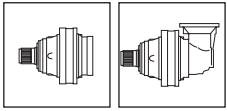

PG 100

YZ Pignoni / Pinion Pignon / Ritzel



	Versione Output type Version Abtriebs- version	M	Z	XM	A	B	C	D	E	F	G	K	Materiale Material Matière Material	Codice Code Code Bestell - Nr.
A	M.. - P..	1.9	20	0.049	65	—	6	20.5	84.5	42	42	—	38NiCrMo4	1701.200.042
	M.. - P..	5	16	2.5	55	—	6	20.5	95	42	42	—	38NiCrMo4	1701.259.042
B	M.. - P..	3.5	23	0	40	60.5	6	20.5	87.5	42	42	60	38NiCrMo4	1701.291.042

BS Boccola scanalata / Splined bushing Moyeu cannelé / Innenverzahnte Buchse



Materiale / Material
Matière / Material
UNI C40
SAE 1040
DIN Ck40

Codice / Code
Code / Bestell - Nr.
1710.100.076

FF Fondello di arresto / Stop bottom plate Bouchon de fermeture / Endscheibe



Codice / Code
Code / Bestell - Nr.
5701.034.000

FL Flangia / Flange Bride / Flansch



Codice / Code
Code / Bestell - Nr.
1710.102.025

KB Barra scanalata / Splined rod Arbre cannelé / Außenverzahnte Welle



Materiale / Material
Matière / Material
UNI 39NiCrMo3
bonificato
hardened and tempered
bonifié
vergulst

Codice / Code
Code / Bestell - Nr.
1703.179.042

GA Giunto di attrito / Shrink disc Frette de serrage / Schrumpfscheibe



Coppia max.
Max. torque
Couple max.
Max. Drehmoment
2.2 kNm

Codice / Code
Code / Bestell - Nr.
9015.062.000

PG 100

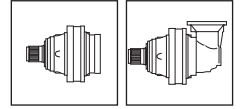

CARICHI RADIALI (Fr)

Nei diagrammi seguenti sono riportati i carichi radiali e i coefficienti K per rapportarli al valore $n_2 \times h$ desiderato.

RADIAL LOADS (Fr)

The following curves show the radial loads and the K factors to obtain the required $n_2 \times h$ value.

CHARGES RADIALES (Fr)

Dans les diagrammes suivants sont indiqués les charges radiales et les facteurs K de façon à obtenir la valeur $n_2 \times h$ désirée.

RADIALLAST (Fr)

In den nachstehenden Diagrammen ist die Radiallast und der Koeffizient K dargestellt und kann mit dem gewünschten Wert $n_2 \times h$ verglichen werden.

M

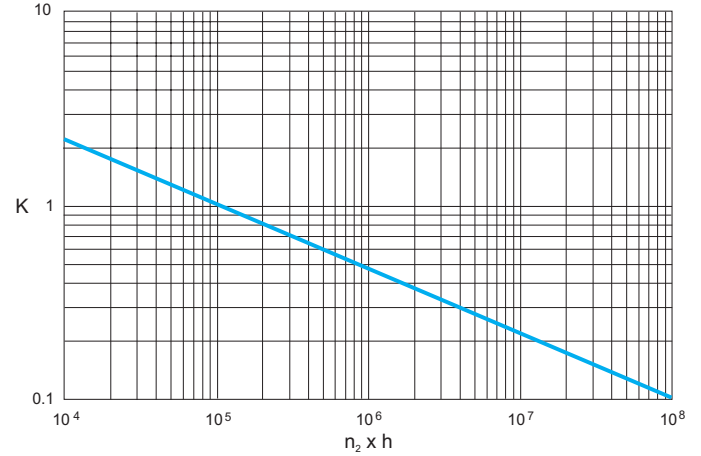
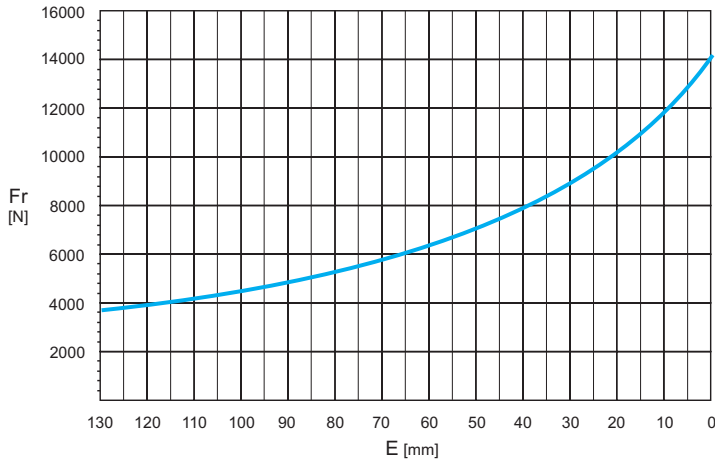

P - CPC*

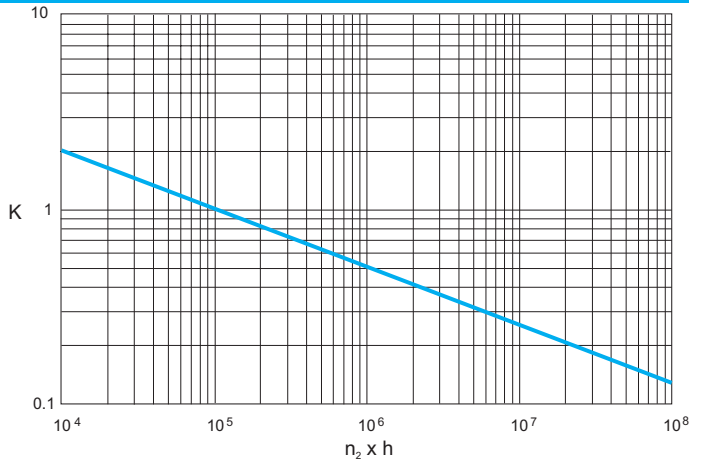
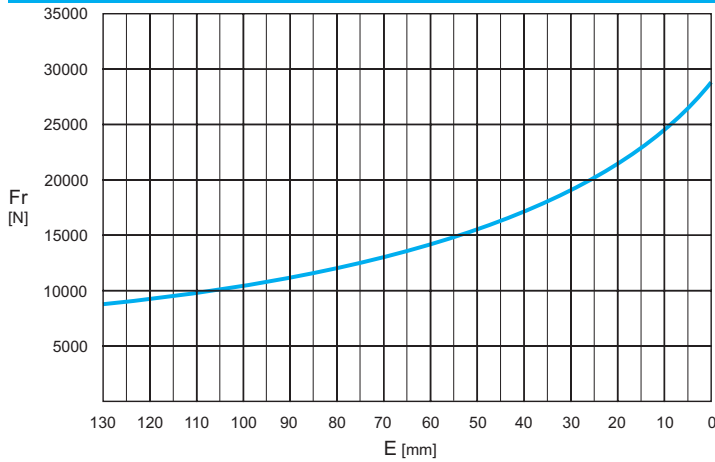

	$n \times h$				
	10^5	10^4	10^6	10^7	10^8
M - P	Fr			Fr • K	
*CPC	Fr • 0.75			Fr • K • 0.75	

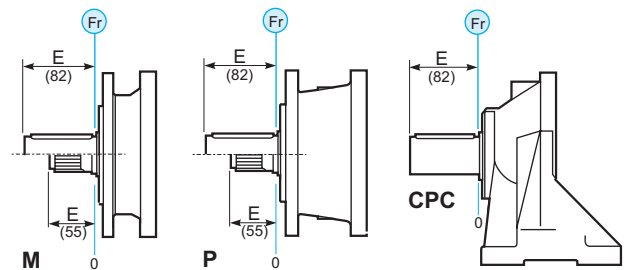

CARICHI ASSIALI (Fa)

I valori dei carichi assiali indicati in tabella sono riferiti alle versioni e alla direzione di applicazione del carico.

AXIAL LOADS (Fa)

The values of the axial loads in the table refer to the output versions and load direction of application.

CHARGES AXIALES (Fa)

Les valeurs des charges axiales indiquées dans le tableau se réfèrent aux versions et à la direction d'application de la charge.

AXIALLAST (Fa)

Die dargestellten Werte der Axiallast basieren auf der Version und der applizierten Lastrichtung.

Fa [N]	M	P - CPC	← →
		16000	

